

Double Leaf EI₂₃₀ / T30 Fire Retardant Acoustic Gate

Fire Protection	EI₂₃₀ / T30	tested acc. to EN 1634-1
Sound Insulation	R_{w,P} 38 dB	tested acc. to EN ISO 10140-2
Smoke Control (optional)	S_a, S₂₀₀ / RS	tested acc. to EN 1634-3
Self-Closing (optional)	up to C2	tested acc. to EN 1191

Certified in accordance with DIN EN 16034 / 14351-1 / 13241

Optional Audited Additional Functions

- Burglar Protection	RC2/RC3/RC4/RC5	tested acc. to EN 1627
- Bullet Resistance	FB4-NS	tested acc. to EN 1522
- Air Tight	up to class 3	tested acc. to EN 12426
- Rain- and Fire-Water Tight	class 1	tested acc. to EN 12425
- Wind Load Resistance	class 4	tested acc. to EN 12424
- Blast Resistance	up to 8 kPa	tested acc. to EN 13124-1
- Explosion Protection	up to zone 1/21	acc. to EN 1127-1 or ATEX 2014/34/EU
- Stainless Steel		

Range of Dimension

Width from 3000 mm to 5000 mm
Height from 3000 mm to 5000 mm

Technical Specification and Tender Text

Product:	EI₂₃₀ / T30 double leaf fire retardant acoustic gate brand Buchele tested acc. to EN 1634-1 und EN ISO 10140-2
Door Type:	PLANE Line PL 302 XXL BASIC
Sound Insulation R_{w,P}	40 dB
Rohbauöffnung: x mm
Door Leaf:	Double-walled, planar 84 mm thick steel door leaf without hinge embossing, three sides rebated with thick rebate Without bottom stop. Special insulating inserts fully laid-in and glued. Passive leaf with multi-chamber sealing profile in the middle rebate. Securing pin screwed in door leaf rebate. Drop sealing system.
Threshold:	Floor bracket as separation sill. Surface galvanized and welded to the frame.
Frame:	3-sided circumferential rebated corner frame with visible black coated intumescent material in rebate. High-quality multi chamber sealing profile adjustable fixed in the three-sided groove.
Hinges:	Three-part, height adjustable construction hinges with hinge pin retention and ball bearing spacer ring for smooth door movement.

Door Closer:	2 pieces door closer system with standard arm acc. to EN 1154 silver coloured mounted on hinge side. Door coordinator and 2 pieces of 30 mm high brackets with plastic roller.	
Fitting:	Active leaf with mortise lock with latch lever function acc. to EN 12209 (prepared for installation of a profile cylinder lock, provided by customer). Door handle set in acc. to EN 1906 fixed pivoted synthetic material black in U-shape with rounded short-plate. Passive leaf with self-locking concealed shoot bolt lock with upper switch lock.	
Surface:	Door leaf and frame galvanized und primed with 2K-PUR primer (Very High Solid) similar RAL 7035.	
Installation:	masonry	≥ 240 mm
	concrete	≥ 240 mm
	areated concrete	on request
	mounting wall F60	on request

Alternative: PLANE Line PL 302 PREMIUM with flush mounted optics

Frame:	3-sided circumferential rebated PLANE Line special corner frame for flush mounted optics on hinge side. With visible, black coated intumescent material in rebate. High-quality multi-chamber sealing profile adjustable fixed in the three-sided groove.	
Hinges:	Three-part, height adjustable construction hinges with hinge pin retention and ball bearing spacer ring for smooth door movement.	
Door Closer:	Up to gate width of 3300 mm Slide rail door closer system acc. to EN 1154 silver coloured mounted on hinge side. From gate width of 3300 mm 2 pieces door closer system with standard arm acc. to EN 1154 silver coloured mounted on hinge side. Door coordinator and 2 pieces of 30 mm high brackets with plastic roller.	

Supplementary Equipment

Glazing:	F30 fire-protective glazing fixed with profiled and visible screwed steel glazing bars. Range of dimension on request.	
Stainless Steel:	Material 1.4301 (V2A) or 1.4404 (V4A), Surface mill finish or brushed.	
BUCHELE DELUXE:	The exclusive surface coating.	

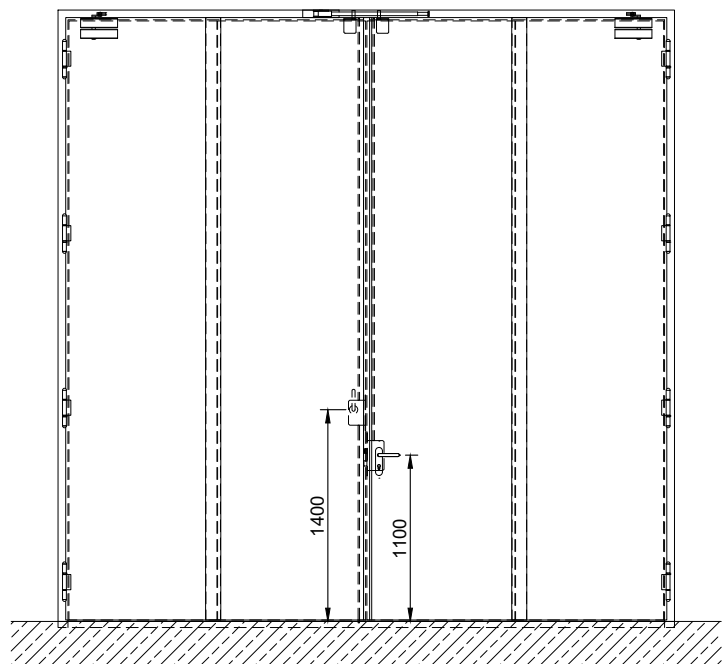
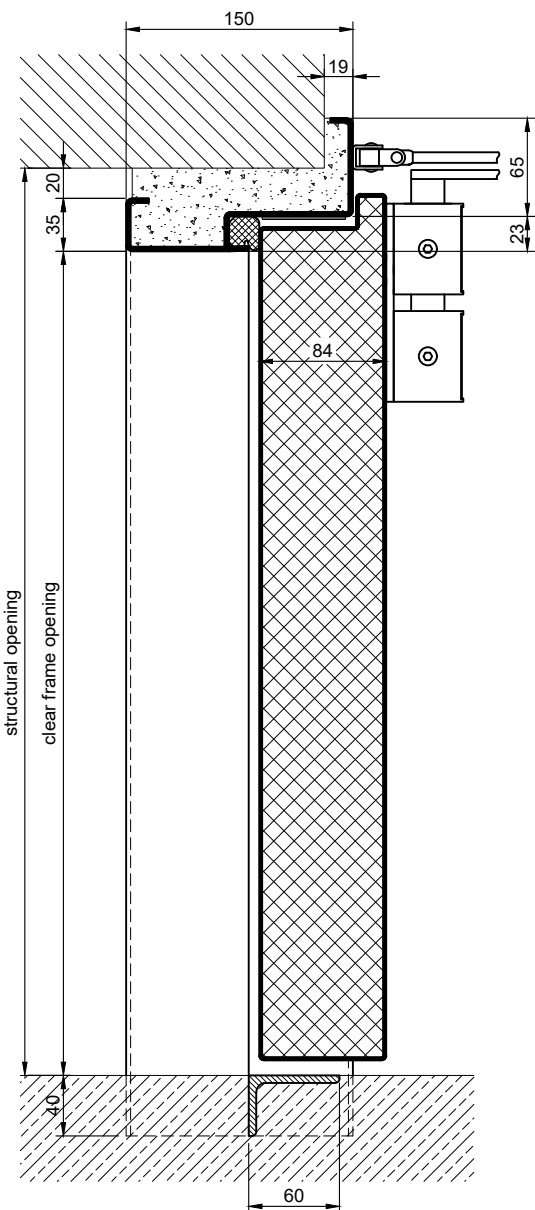
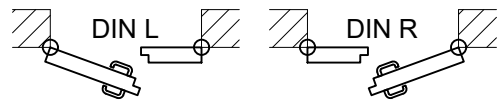
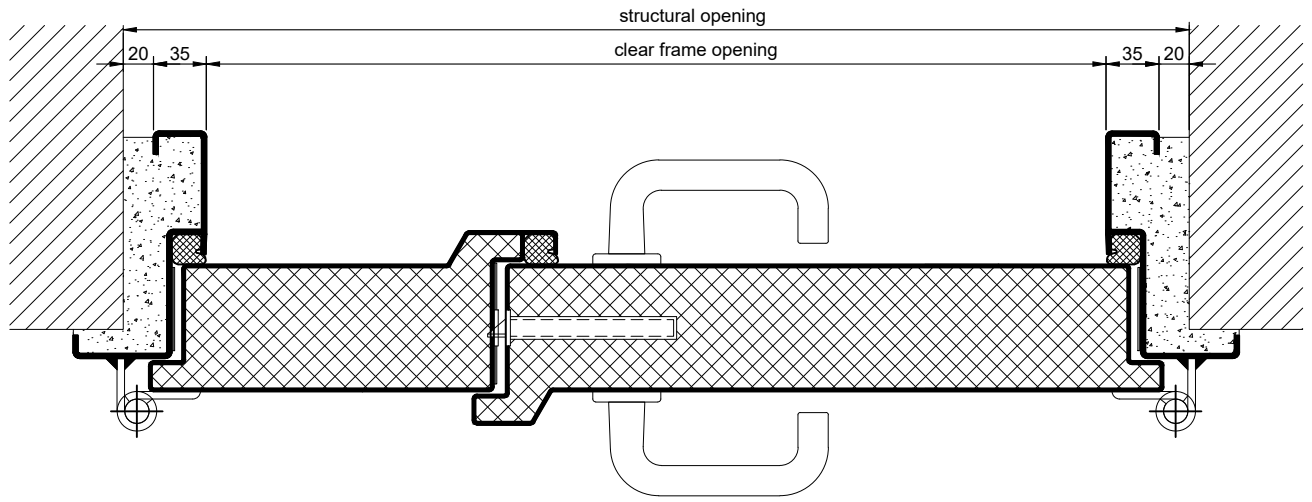

1.11.14_PLANE LINE PL 302 XXL 40 DB_EN

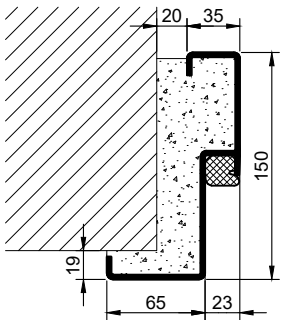
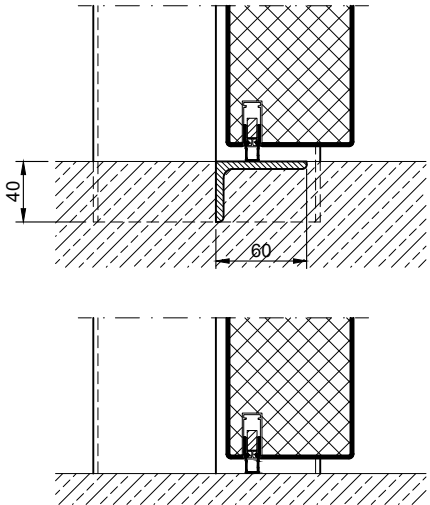
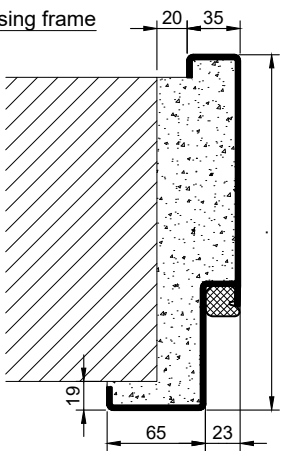
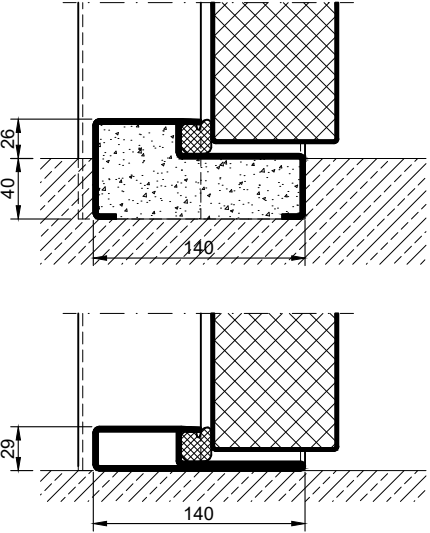
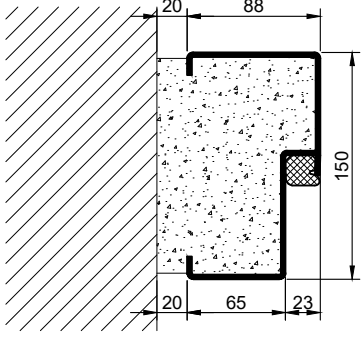
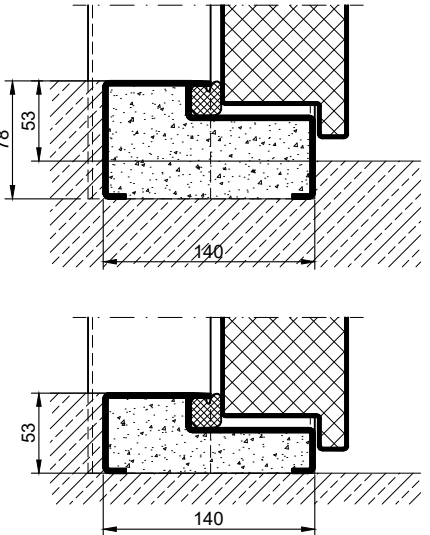
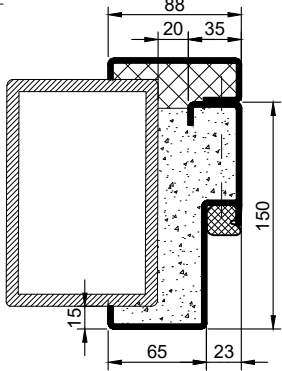
Frames	Thresholds	
<p>corner frame</p> 	<p>drop seal</p> 	
<p>encasing frame</p> 	<p>stop sill with seal</p> 	
<p>block frame</p> 	<p>full sill</p> 	
<p>corner frame with counter frame</p> 		

1.11.14_PLANE LINE PL 302 XXL 40 DB_EN